

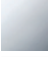



ST 050 301 6360



- shower with fixed riser projection 420mm
- Rain shower: PURE RAIN, max. flow rate 14 l/min (at 3 bar)
- Function from: 8 l/min
- rain shower Ø 200 mm
- Hand shower: COMPACT RAIN, max. flow rate 9 l/min (at 3 bar)
- spray head Ø 64mm
- rotary diverter for fixed-riser shower/hand shower
- height of fittings up to top edge of elbow 1180mm
- height of fittings up to rain shower (bottom edge) 1009mm
- rosette for shower holder Ø 66mm
- rosette for wall mounting Ø 70mm
- rosette for shower mixer Ø 60mm
- gauge 150 mm - 13 mm
- metal shower hose 1250mm with integrated anti-twist protection
- 1/2" connection
- Pipe diameter 20 mm

| | | |
|--|--------------------------------|--------------------|
|  | Chrome | ST 050 301 6360-00 |
|  | Brushed Platinum | ST 050 301 6360-06 |
|  | Platinum | ST 050 301 6360-08 |
|  | Durabronze (23kt Gold) | ST 050 301 6360-09 |
|  | Brushed Durabronze (23kt Gold) | ST 050 301 6360-28 |
|  | Brushed Dark Platinum | ST 050 301 6360-99 |

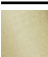
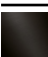
Individual components of this set

You need the following components for this set

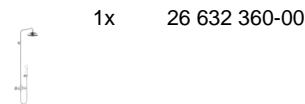
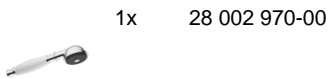



MADISON Showerpipe with shower mixer - Chrome

MADISON

ST 050 301 6360

ST 050 301 6360



- COMPACT RAIN, max. flow rate 9 l/min (at 3 bar)
- Function from: 6 l/min
- spray head Ø 64mm
- 1/2" connection
- WRAS 1809019

Intrinsic protection against back flow.

| | | |
|--|-------------------------------|--------------------|
|  | Chrome | 28 002 970-00 |
|  | Chrome | 28 002 970-00 0010 |
|  | Gold (23.9kt) | 28 002 970-01 |
|  | Brushed Platinum | 28 002 970-06 |
|  | Brushed Platinum | 28 002 970-06 0010 |
|  | Platinum | 28 002 970-08 |
|  | Platinum | 28 002 970-08 0010 |
|  | Durabress (23kt Gold) | 28 002 970-09 |
|  | Durabress (23kt Gold) | 28 002 970-09 0010 |
|  | Brushed Durabress (23kt Gold) | 28 002 970-28 |
|  | Brushed Durabress (23kt Gold) | 28 002 970-28 0010 |
|  | Brushed Chrome | 28 002 970-93 |
|  | Brushed Chrome | 28 002 970-93 0010 |
|  | Brushed Dark Platinum | 28 002 970-99 |
|  | Brushed Dark Platinum | 28 002 970-99 0010 |

ST 050 301 6360

mm [inches]

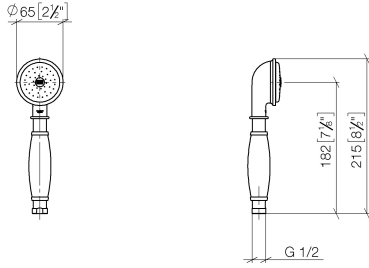

Flow rate chart

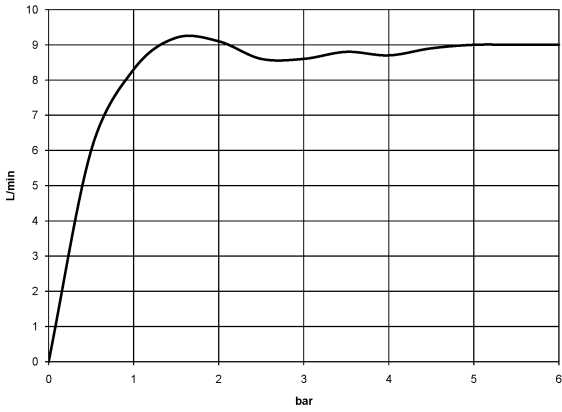

Certificates

WRAS_1809019. LGA_8492.

ST 050 301 6360

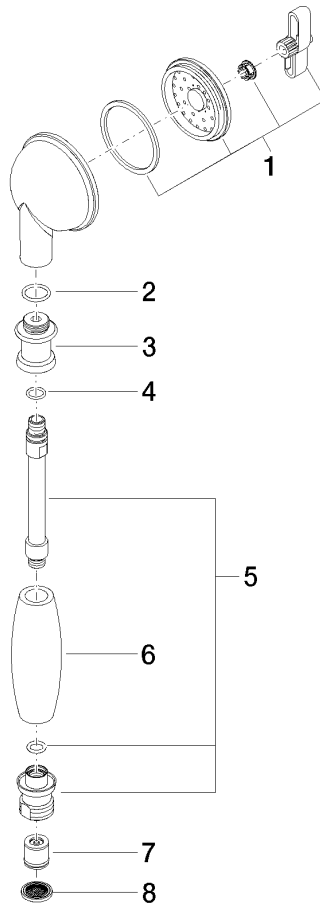

Spare parts list

| No. | Item Number | Name | Quantity used | Delivery time |
|-----|--------------------|--------------|---------------|---------------|
| 1 | 90 12 01 010 00 90 | set | 1 | 2 |
| 2 | 09 14 10 069 90 | seal | 1 | 2 |
| 3 | 09 24 04 059 20-00 | nipple | 1 | 10 |
| 4 | 09 14 10 042 90 | seal | 1 | 2 |
| 5 | 90 28 22 033 00-00 | insert | 1 | 10 |
| 6 | 11 167 820 60 | handle | 1 | 2 |
| 7 | 09 23 01 077 90 | flow reducer | 1 | 2 |
| 8 | 09 23 01 039 90 | sieve | 1 | 2 |

ST 050 301 6360









- shower with fixed riser projection 420mm
- overhead shower: rain flow
- rain shower Ø 200 mm
- max. rainshower flow 14 l/min
- Function from: 8 l/min
- rotary diverter for fixed-riser shower/hand shower
- height of fittings up to top edge of elbow 1180mm
- height of fittings up to rain shower (bottom edge) 1009mm
- rosette for shower holder Ø 66mm
- rosette for wall mounting Ø 70mm
- rosette for shower mixer Ø 60mm
- gauge 150 mm - 13 mm
- metal shower hose 1250mm with integrated anti-twist protection
- 1/2" connection
- Pipe diameter 20 mm
- This product can help a building meet the requirements of Green Building Rating Systems, e.g. LEED®, BREEAM®, DGNB

This article does not include a hand shower!

Intrinsic protection against back flow.

This article does not include a hand shower!

Intrinsic protection against back flow.

| | | |
|--|-------------------------------|---------------|
|  | Chrome | 26 632 360-00 |
|  | Brushed Platinum | 26 632 360-06 |
|  | Platinum | 26 632 360-08 |
|  | Durabrace (23kt Gold) | 26 632 360-09 |
|  | Brushed Durabrace (23kt Gold) | 26 632 360-28 |
|  | Brushed Dark Platinum | 26 632 360-99 |

Required miscellaneous



- MADISON Hand shower - Chrome** 28 002 978-00
- spray head Ø 95mm
 - Hand shower see page {PAGE}
 - Three settings: COMPACT RAIN, COMPACT SOFT FLOW, COMPACT AQUAPRESSURE FLOW, max. flow rate l/min (at 3 bar)

Required miscellaneous



- MADISON Metal hand shower with porcelain insert (white) FlowReduce - Chrome** 28 002 970-00 0010

Required miscellaneous



- MADISON Hand shower FlowReduce - Chrome** 28 002 978-00 0010
- spray head Ø 95mm
 - Hand shower see page {PAGE}
 - Three settings: COMPACT RAIN, COMPACT SOFT FLOW, COMPACT AQUAPRESSURE FLOW, max. flow rate l/min (at 3 bar)



MADISON Showerpipe with shower mixer - Chrome

MADISON

ST 050 301 6360

ST 050 301 6360

mm [inches]

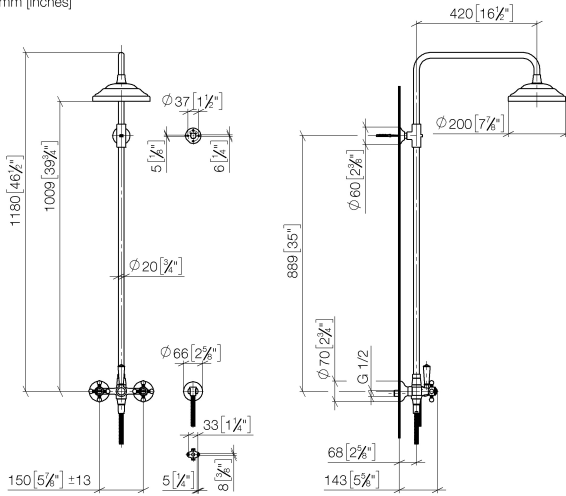

Flow rate chart

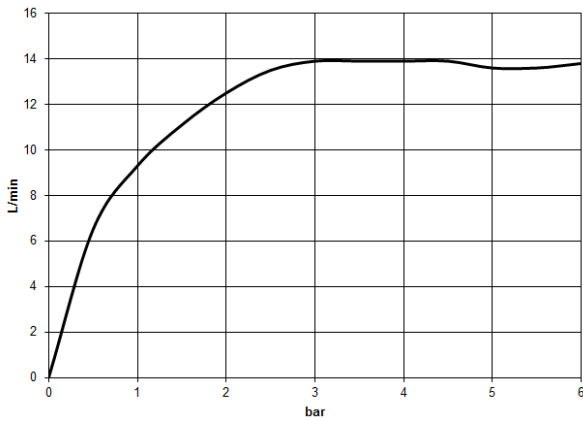

Certificates

Belgaqua_21-023- WRAS_2204012.
27_8.

ST 050 301 6360

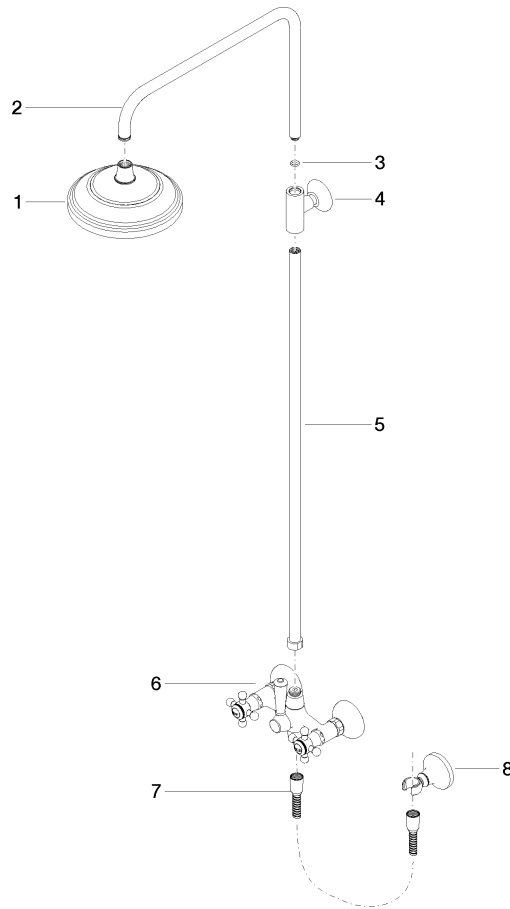

Spare parts list

| No. | Item Number | Name | Quantity used | Delivery time |
|-----|--------------------|--|---------------|---------------|
| 1 | 04 12 05 038 01-00 | shower | 1 | 60 |
| 2 | 04 28 22 101 20-00 | spout | 1 | 10 |
| 3 | 90 14 10 011 00 90 | seal | 1 | 2 |
| 4 | 90 17 11 033 00-00 | holder | 1 | 10 |
| 5 | 90 28 22 096 00-00 | pipe | 1 | 10 |
| 6 | 04 17 10 001 00-00 | fitting | 1 | 60 |
| 7 | 28 104 970-00 | Metal shower hose 1/2" x 1/2" x 1250 mm - Chrome | 1 | 2 |
| 8 | 28 050 410-00 | holder | 1 | 60 |